

RESIDENTIAL DRAFTING SERVICES

158 NORTH SHORE ROAD, GRAFTON, ON, K0K 2G0
289 251 4144
ellen@residentialdrafting.ca

These drawings and specifications are confidential and proprietary and shall remain the sole property of Residential Drafting Services, which is the owner of the copyright of this Work. These drawings and specifications may not be reproduced (in whole or in part), altered, stored with third parties or used in any manner on other projects or extensions to this project without the express written consent of Residential Drafting Services, and are not to be used for construction unless signed by the Designer.

Examine the drawings carefully before commencing the Work. Report any discrepancies to the Designer and obtain clarification of additional instructions before proceeding with that part of the Work.

Do not commence the Work unless the drawing is Issued For Construction.

Do not scale drawings

The undersigned has reviewed and takes responsibility for this design, and has the qualifications and meets the requirements set out in the Ontario Building Code to design the work shown on the attached documents. See Schedule 1: Designer Information sheet for scope of work.

Qualified Designer:
ELLEN ABRAMCZYK, B.C.I.N. - 28276

Registered Firm:
RESIDENTIAL DRAFTING SERVICES, B.C.I.N. - 33083

NO.	DESCRIPTION:	DATE:
3	Revised Permit Issue	18/03/20
2	Permit Issue	29/09/19
1	Preliminary Issue	27/09/19

CLIENT: FSD Pharma Inc.
520 William Street
'Certo Building'
Cobourg, ON

DESIGNER: Ellen Abramczyk
B.C.I.N. 28276

SITE: 520 William Street
'Certo Building'
Cobourg, ON

TITLE: Section , Detail

SCALE:	As Shown	DATE:	9/25/19
PROJECT NO:	19228	SHEET NO:	A-2
REVISION:		REVISION:	1

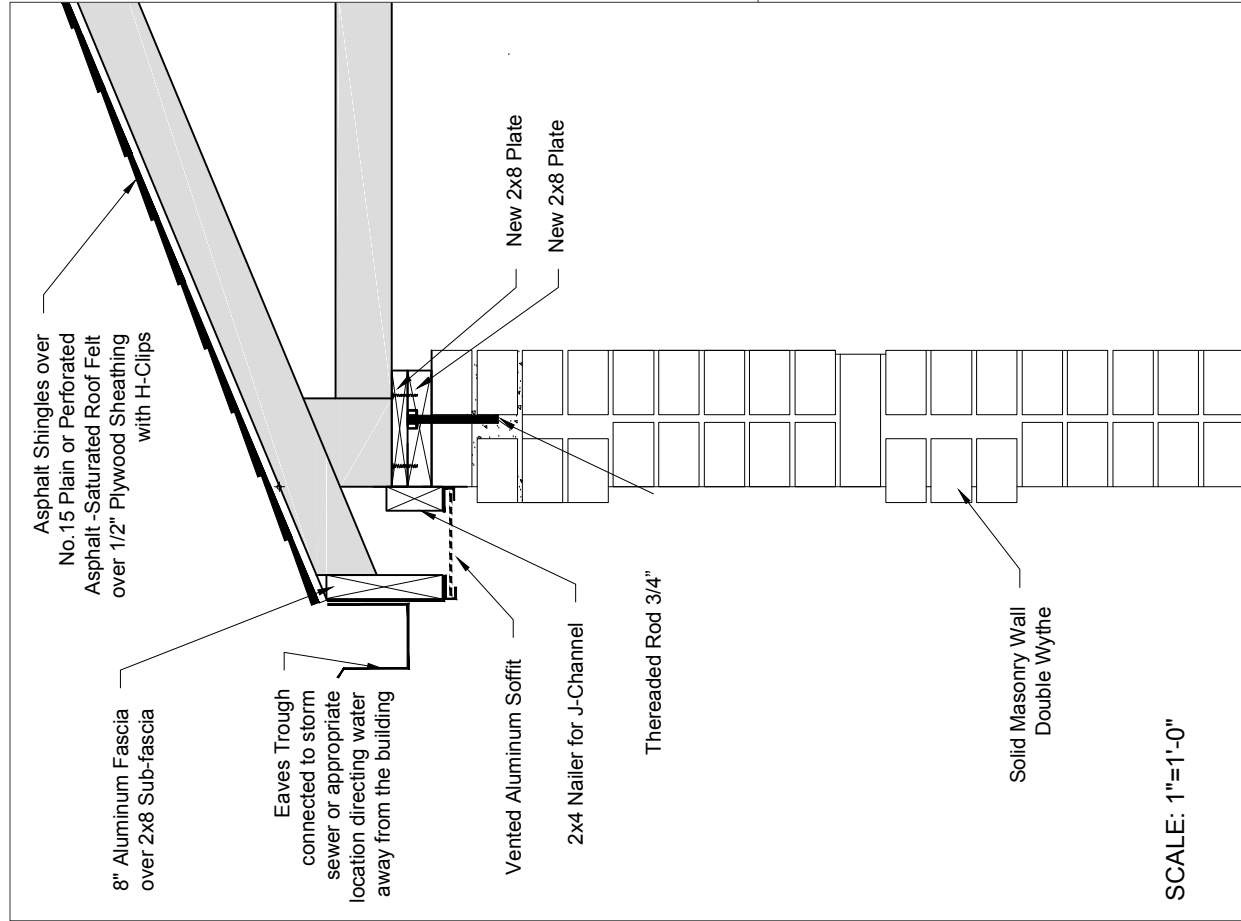

GENERAL REQUIREMENTS:

- USE ONLY THE LATEST ISSUES OF ANY GOVERNMENT CODES, STANDARDS, OR REGULATIONS MENTIONED IN THE FOLLOWING NOTES.
- EXCEPT WHERE NOTED OTHERWISE, PROVIDE ALL MATERIALS AND WORKMANSHIP IN ACCORDANCE WITH THE REQUIREMENTS OF THE ONTARIO BUILDING CODE (OBC) AND ITS LATEST REGULATIONS.
- CHECK ALL DIMENSIONS, LEVELS, AND ELEVATIONS PROVIDED BY THE STRUCTURAL DRAWINGS WITH OTHER CONTRACT DOCUMENTS AND REPORT ANY INCONSISTENCIES TO THE ENGINEER BEFORE PROCEEDING WITH THE WORK.
- REPORT ANY DISCREPANCIES IN CONNECTION WITH SPECIFICATIONS AND OTHER CONTRACT DOCUMENTS TO THE ENGINEER IMMEDIATELY.
- SPECIFIC NOTES AND DETAILS SHOWN ON THE STRUCTURAL DRAWINGS TAKE PRECEDENCE OVER THE GENERAL NOTES AND TYPICAL DETAILS.
- COORDINATE WITH ALL OTHER TRADES WHERE SUCH TRADES AFFECT THE STRUCTURE.
- THE STRUCTURAL DESIGN OF THE BUILDING IS BASED ON THE FULL INTERACTION OF ALL ITS COMPONENT PARTS. NO PROVISIONS HAVE BEEN MADE FOR CONDITIONS OCCURRING DURING CONSTRUCTION. TAKE APPROPRIATE PRECAUTIONS TO KEEP THE STRUCTURE PLUMB AND LEVEL DURING ALL PHASES OF THE WORK.
- NO HOLES, OTHER THAN THOSE APPROVED BY THE ENGINEER, WILL BE PERMITTED THROUGH STRUCTURAL MEMBERS.
- CONTRACTOR SHALL CHECK ALL STRUCTURAL DRAWINGS AND DIMENSIONS WITH ARCHITECTURAL DRAWING.
- CONTRACTOR SHALL VERIFY ALL DIMENSIONS IN SITE.
- CONTRACTOR SHALL CONSIDER AND PERFORM ALL SAFETY MEASURES TO PROTECT LABOR AND PUBLIC.
- CONTRACTOR SHALL VERIFY ALL OPENING SIZES.
- NOTES AND DETAIL DRAWINGS TAKE PRECEDENCE OVER GENERAL STRUCTURAL NOTES AND TYPICAL DETAILS.
- CONTRACTOR SHALL CONSTRUCTION CONDITION THAT JEOPARDIZE SAFETY OF LABOR AND/OR PUBLIC, AT THE TIME AND/OR IN FUTURE.
- IN CASE OF EXISTENCE OF DISCREPANCIES BETWEEN THE PROJECT SPECIFICATIONS AND THE GENERAL STRUCTURAL NOTES, THE MOST CONSERVATIVE GOVERNMENT CODES, STANDARDS, REGULATIONS, AND TYPICAL DETAILS, NOT BE A BASIS FOR CONTRACTOR FAILURE OR ANY BACK-CHARGE OR ADDITIONAL CLAIM.

DESIGN LOADS:

IMPORTANCE FACTOR, I.E: 1

ROOF DEAD LOAD: 1.0KPa

ROOF LIVE LOAD: 1.0KPa

SNOW LOAD: 1.36KPa

EQUIPMENT ROOF DEAD LOAD: 0.2KPa

MAX. WIND LOAD: 0.51KPa

EARTH QUAKE: 0.1KPa

LOCATION: COBOURG, ONTARIO

SI(0.2): 0.179

SI(0.5): 0.106

SI(1.0): 0.059

SI(2.0): 0.03

PGA: 0.113

SITE CLASS: D

MATERIAL: BRICK

SYSTEM: WALLS

TEMPORARY SHORING AND BRACING NOTES:

- THE CONTRACTOR IS RESPONSIBLE FOR THE STRENGTH, SAFETY, AND STABILITY OF THE NEW AND EXISTING STRUCTURE DURING CONSTRUCTION AND SHALL PROVIDE TEMPORARY SHORING, BRACING AND OTHER ELEMENTS REQUIRED TO MAINTAIN STABILITY UNTIL THE STRUCTURE IS COMPLETE.
- IT IS CONTRACTOR'S RESPONSIBILITY TO BE FAMILIAR WITH THE WORK REQUIRED IN THE CONSTRUCTION DOCUMENTS AND THE REQUIREMENTS FOR EXECUTING IT PROPERLY.
- THE CONTRACTOR SHALL AT HIS DISCRETION EMPLOY A REGISTERED PROFESSIONAL ENGINEER FOR THE DESIGN OF ANY TEMPORARY BRACING AND SHORING.

NOTES:
1- CONTRACTOR IS RESPONSIBLE TO PROVIDE SHOP DRAWINGS FOR ENGINEER REVIEW BEFORE CONSTRUCTION.
2- FOR DIMENSIONS AND INSTALLATION DETAILS, REFER TO SHOP DRAWINGS.

Section A

SCALE: 1/4"=1'-0"

NOTES:
Plans for the replacement of a existing rafter framed roof and ceiling with Engineered Trusses.

Contractor to verify all measures.

All lumber used shall be SPF#1,2 or better unless noted otherwise.

Attachment of roof trusses to sill plate requires min 3 - 3 1/4" nails toe nailed at each truss to sill contact.

